

GENERAL MOBILE

GMPods 2

**Wireless Bluetooth Earphones
Quick Start Guide**

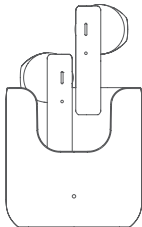

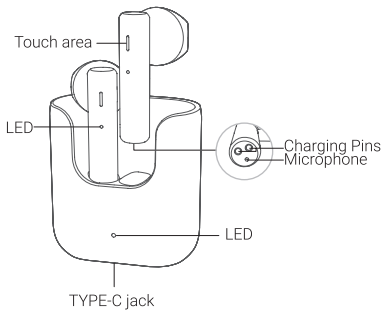

Pairing with the Device

Initial Pairing;

To activate the earphones, take them out of the charging box. Search for GMPods 2 on your smart device after they pair with each other automatically and tap to connect.

To Change A Paired Device:

1. In order to disconnect the earphone and enable the pairing mode, turn off the Bluetooth connection of device A.
 2. Search for GMPods 2 on device B and tap to connect.
- *Multi-connection is not supported. Earphones will be automatically connected to device B and turned on again.

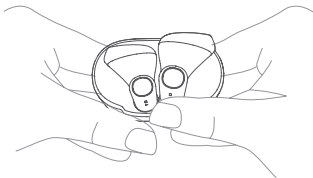

Factory Settings

Try the steps below to fix the connection issue)

- 1.If your smart device has a connection record, delete it.
- 2.Place the earphones in the charging box and tap and hold the earphone panels for 10 seconds or until the red and green LEDs flash 3 times to restore the factory settings.

After these steps, the earphones will be automatically paired with each other after you take them out of the charging box.

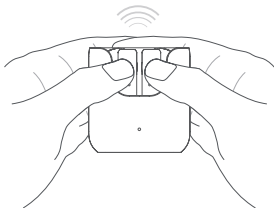

Putting your earphones on

1. Turn the earphones and put them in your ear, then shake your head to check the wearing stability.
2. Adjust the microphone towards your mouth to get better calling and speaking experience.
3. Please put the earphone heads in your ears correctly, make sure that they fit tightly and the sound holes are inside the ear canals.

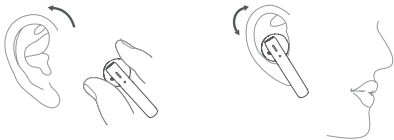

Single Mode

Make sure that the earphones are already paired. Touch the panels on both earphones for 2 seconds to activate your earphones. They will be automatically ready for connection in 5 seconds (the LED will flash blue).

Search for GMPods 2 on your smart device and tap to connect.

While Charging the Earphone

To charge the earphone, place it inside the charging box.

The earphones will automatically turn themselves off and start charging.

Charging the Charging Box

When the charging box is charging, the LED on the box will turn red and when it is fully charged, the LED will turn green. When the earphones are charging, the LED on the earphones turns red; and after they are fully charged, it turns green for 1 minute.

Details of the Function

Functions	Current Status	Operation/result	LED	Response
On	Earphones are not in the charging box	Tap and hold the panel for 1.5 seconds	The LED will flash green	TONE
	Earphones are in the charging box and plugged in the charger	Open the cover of the charging box	The LED will flash green	
Off	Earphones are on and the charging box is being charged	Put the earphones in the charging box to turn them off	They will be charged, the LED will turn red	\
	Earphones are on	Tap the panel for 5 seconds.	LED light will turn red for 2 seconds	TONE
Answering / Ending a call	Incoming call/dialing	Tap the bar twice successively	\	TONE

Details of the Function

Functions	Current Status	Operation/result	LED	Response
Muting the call	Incoming call	Keep holding the bar for 1.5 seconds	\	TONE
Voice Assistant	Connected	Tap the left earphone 3 times successively	\	TONE
Pausing /playing music	Music playing	Tap 2 times successively to stop or resume	\	\
Skipping to previous song	Music playing	Tap and hold the left earphone to rewind	\	\
Skipping to next song	Music playing	Tap and hold the right earphone to fast forward	\	\
Game mode	Connected	Tap the right earphone 3 times successively to turn the game mode on or off	\	TONE

Dangerous Chemicals in the Product and Their Contents

Part Name	Dangerous Substances									
	Pb	Hg	Cd	Cr (VI)	PBB	PBDE	DIBP	DEHP	DBP	BBP
Main Section	X	0	0	0	0	0	0	0	0	0
Battery	0	0	0	0	0	0	0	0	0	0
Earphone Types	0	0	0	0	0	0	0	0	0	0
Accessories	0	0	0	0	0	0	0	0	0	0
Charging Cable	X	0	0	0	0	0	0	0	0	0

This form was prepared in accordance with the SJ / T 11364 regulation.

0: means that the content of hazardous chemicals in the homogeneous materials of this part is within the limits of the (EU) 2015/863 regulation.

X: means that the content of hazardous chemicals in at least one homogeneous material of this part is beyond the limits of the (EU) 2016/863 regulation, but still complies with the EU ROHS Directive by exemption.

Note: Please use the time correctly, as using the device for a long time will damage your hearing.

Apply the standard: Q / HL 1-2019; Q / HL 2-2017 Manufacturer: Dongguan Hele Electronics Co., Ltd. Address: Daojiao Town, Dongguan City, Guangdong, China

Tips and Warnings

Tips

1. Before using your earphone, please read the guide carefully and save it for future reference.
2. The earphones need to be fully charged before the initial use.
3. If the earphones will not be used for more than two weeks, please remember to charge them regularly.
4. Please use chargers manufactured by an approved manufacturer.
5. If your earphones cannot be detected by your phone, please check if they are in the pairing mode. If left unconnected for a long time, the earphones will exit the pairing mode, please re-enable the mode. If a procedural error occurs on your phone, restart it. If a procedural error occurs on your earphones, restart or reset them.

Warnings!

1. To avoid damages or dangerous situations, never disassemble or modify your earphones for any reason.
2. Do not store the earphones in extreme temperatures (below 0°C or above 45°C).
3. Avoid using the indicator close to the eyes of children or animals.
4. Do not use the earphones during a storm to avoid erratic functions and increased risk of electric shock.
5. Do not use abrasive chemicals or strong detergents to clean the earphones.
6. Keep the earphones dry.



RoHS

CMIIT ID: 2019DP10326 FCC ID: RDR-IN1933

DECLARATION OF CONFORMITY

Product Description:

True Wireless Stereo Bluetooth Earphone

Brand : General Mobile

Model : GMPods 2

We hereby declare that the above named products is in conformance to all the essential requirements of the directive RED To which this declaration relates, is in conformity with the following standards and/or other normative documents.

EN 62479:2010

EN IEC 62368-1:2020

ETSI EN 301 489-1 V2.2.3 (2019-11)

ETSI EN 301 489-17 V3.2.4 (2020-09)

ETSI EN 300 328 V2.2.2 (2019-07)

Manufacturer:

Dongguan Hele Electronics Co., Ltd

Importer:

Telpa Teknoloji Hizmetleri A.S.

İkitelli OSB Mahallesi 17. Cadde,

No:3, 34490 Basaksehir

İSTANBUL /TURKEY

Sebahattin YAMAN/CEO

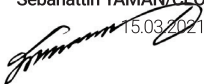

15.03.2021

GENERAL MOBILE