

# GENERAL MOBILE

## GM Pods 3

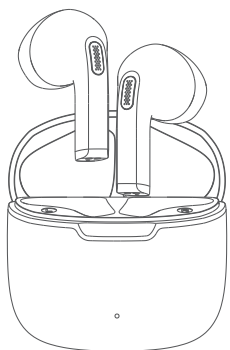

### User Manual

#### Overview

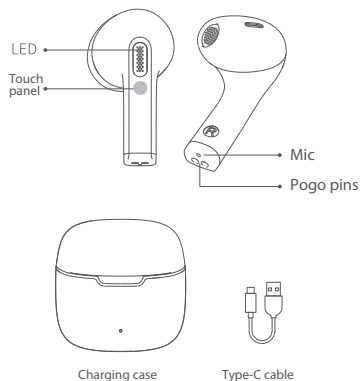

Above pictures are for reference only yet practical accessories may vary.

#### How to Connect

##### First Time Pairing:

1. Pick up both earbuds, pop them back in case to activate.
  2. Pick them up again
  3. On your phone, search "GM Pods 3" and tap to connect.
- \* Pick up earbuds to power on. Otherwise, please charge the case and try again.

##### Switch Paired Device:

1. Turn off phone A's Bluetooth faculty and earbuds will auto disconnect and turn connectable.
  2. On phoneB, search "GM Pods 3" and tap to connect.
- \* Multi-point connection is not available. Earbuds will auto reconnect to phoneB upon powering up again.

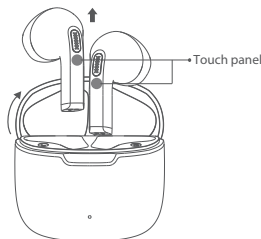

#### Factory Setting

1. Pick up both earbuds after they are fully charged. Turn off Bluetooth of your device and touch both panels 5 times to reset them to factory(LEDs blink white 5 times)
  2. Clear relative connectivity record on phone and reconnect earbuds to phone.
- \* If you fail, please try again.

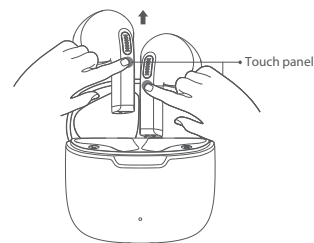

#### LED on Charging Case

When the case is with low battery, LED will blink white 4 times after earbuds pushed in.

#### Use Instruction

##### How to Wear



1. Please put on earbuds properly then adjust them to fit yourself.
2. Keep microphone towards your mouth.
3. It will cause a bad calling or listening experience to wear them in a wrong way.

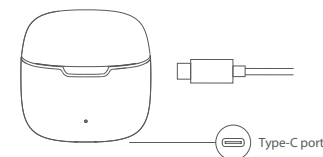

#### LED on Case

Charging: LED blinks white  
Top-up: LED glows solid white

#### Functions

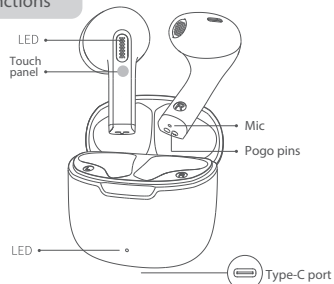

- ⏻ Power-on: pick up earbuds or keep touching panel for 1.5s
- 🔋 Power-off: push earbuds into case
- 🗨️ Answer/end call: double touch panel
- 📞 Ignore call: keep touching panel for 1.5s
- ⏮ Skip track backward: keep touching left panel for 1.5s
- ⏭ Skip track forward: keep touching right panel for 1.5s
- 🔊 Vol+ : When music is playing, touch right panel(This function is not available for calling)
- 🔊 Vol- : When music is playing, touch left panel(This function is not available for calling)
- 🗨️ Voice assistant: triple touch panel
- ⏮ Playback/pause: double touch left/right panel to play/pause
- 🔋 Low-latency mode: triple touch right panel

#### Warranty Card

##### Warranty Period

24 months after you purchase this item (or you may inquire your local shopper for more details).

Supposing any defects caused by quality issues occur within the warranty period, please take this warranty card and purchase receipts to your distributor for free exchange service.

Model Number:
Date of Purchasing:
User's Name:
User's Phone:
User's Address:
Shop's Name:
Shop's Address:
Comments:

Free exchange service will not be accessed under following circumstances:

1. Damages caused unauthorized disassembly.
2. Defects or physical damages caused by leaking or dropping off.
3. Damages by act of God. Supposing your item is within any damages or defects except the above circumstances, please return to us or your distributor for free repairing.

#### FCC Statement

This equipment has been tested and found to comply with the limits for a Class B digital device, pursuant to Part 15 of the FCC Rules. These limits are designed to provide reasonable protection against harmful interference in a residential installation. This equipment generates uses and can radiate radio frequency energy and, if not installed and used in accordance with the instructions, may cause harmful interference to radio communications. However, there is no guarantee that interference will not occur in a particular installation. If this equipment does cause harmful interference to radio or television reception, which can be determined by turning the equipment off and on, the user is encouraged to try to correct the interference by one or more of the following measures:

- Reorient or relocate the receiving antenna.
- Increase the separation between the equipment and receiver.
- Connect the equipment into an outlet on a circuit different from that to which the receiver is connected.
- Consult the dealer or an experienced radio/TV technician for help.

This device complies with part 15 of the FCC Rules. Operation is subject to the following two conditions:  
(1) This device may not cause harmful interference, and (2) this device must accept any interference received, including interference that may cause undesired operation.

Changes or modifications not expressly approved by the party responsible for compliance could void the user's authority to operate the equipment.

#### Tips

1. Before using the earbuds, please read the manual carefully and keep it for future references.
2. The earbuds need to be fully charged prior to first-time use.
3. If the earbuds are left unused for over two weeks, please recharge.
4. Please use the chargers made by qualified manufacturer.
5. If earbuds fail to be found by phone, please re-program them connectable or restore factory settings. If a program error of phone occurs, please turn off and on Bluetooth function or reboot the phone.

#### Caveats

1. Never disassemble or modify your earbuds for any reasons to avoid any damages and danger.
2. Do not store the earbuds in extreme temperatures (under 0°C or over 45°C).
3. Avoid using the indicator close to the eyes of children or animals.
4. Do not use the earbuds during a thunderstorm to avoid dysfunction and increasing risk of electric shock.
5. Do not use harsh chemicals or strong detergents to clean the earbuds.

Note: please do not use earbuds for a long time as may damage your hearing.

Notes: Please arrange using time properly as your hearing may be damaged by using the device for a long time.

Üretici/Manufacturer: Dongguan Hele Electronics Co.,Ltd  
İthalatçı/Importer: Telpa Teknoloji Hizmetleri A.S.  
Hamidiye mah. Anadolu Cad.No:14 Kağıthane İSTANBUL/TÜRKİYE

