

GENERAL MOBILE

GM Pods 3 Pro

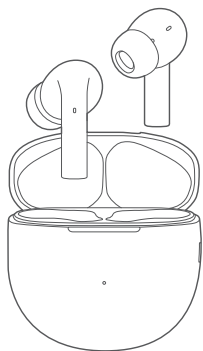

User Manual

Overview

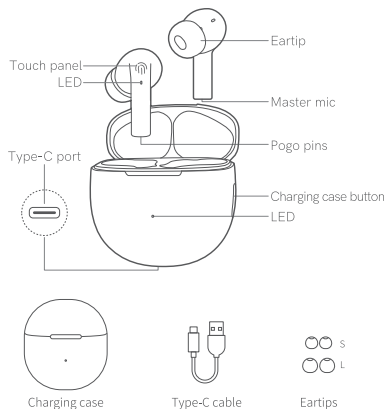

The above pictures are for reference only and practical items may vary.

How to Connect

Open lid to power on earbuds. On phone, search "GM Pods 3 Pro" and tap to connect. If you power them on again, they will auto reconnect to the last device in connectivity records, if any.

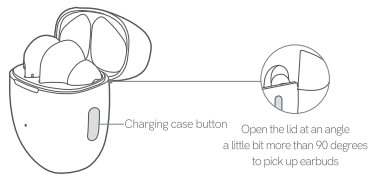

How to Switch Connection Between Two Devices

Push earbuds into case, open lid and keep pressing charging case button for 4s or until LED on one earbud glows solid blue while the other blinks blue. On device, search "GM Pods 3 Pro" and tap to connect.

Multi-Point Connection

1. Open lid and earbuds will auto get connected with Device A. Then turn off Bluetooth function on Device A.
2. On Device B, search and tap "GM Pods 3 Pro" to connect. Then turn on the function on Device A and tap "GM Pods 3 Pro" to finish Multi-Point Connection.

Factory Setting

1. Push earbuds into case and open case. Hold the button on case for 10s to set them to factory.
2. LEDs on earbuds blink white means they are getting reset. After factory resetting, earbuds will auto turn connectable to phone.

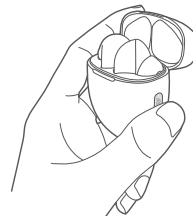

Charge the Case

LED glows solid red when the case is charging
LED glows solid blue when the case is topped up.

LED on Case

Battery level of case $\geq 20\%$ (Blue)
Battery level of case $< 20\%$ (Red)

How to Wear



Please choose eartips to fit yourself.

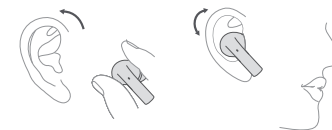

1. Push earbuds into ear canal and shake head to check stability.
2. Adjust mic towards mouth to gain better calling experience.
3. Please put on earbuds properly, getting sound hole towards ear canal.

Instruction

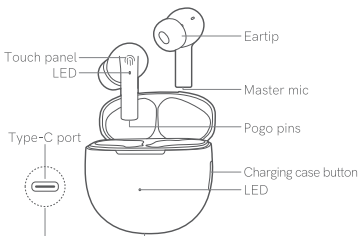

- ⏻ Power-on: keep touching the panel for 1.5s
- ⏻ Power-off: push earbuds back in case and close lid
- 📞 Answer/end call: double touch the panel
- 📞 Ignore call: keep touching the panel for 1.5s
- ⏮ Skip track backward: keep touching left panel
- ⏭ Skip track forward: keep touching right panel
- 🗣 Voice assistant: triple touch left panel
- 🎵 Playback/pause: double touch the panel
- 🎮 Gaming mode: triple touch right panel

Warranty Card

Warranty Period
24 months after you purchase this item (or you may inquire your local shopper for more details).

Supposing any defects caused by quality issues occur within the warranty period, please take this warranty card and purchase receipts to your distributor for free exchange service.

Model Number:
Date of Purchasing:
User's Name:
User's Phone:
User's Address:
Shop's Name:
Shop's Address:
Comments:

Free exchange service will not be accessed under following circumstances:

1. Damages caused unauthorised disassembly.
2. Defects or physical damages caused by leaking or dropping off.
3. Damages by act of God. Supposing your item is within any damages or defects except the above circumstances, please return to us or your distributor for free repairing.

FCC Statement

This equipment has been tested and found to comply with the limits for a Class B digital device, pursuant to Part 15 of the FCC Rules. These limits are designed to provide reasonable protection against harmful interference in a residential installation. This equipment generates uses and can radiate radio frequency energy and, if not installed and used in accordance with the instructions, may cause harmful interference to radio communications. However, there is no guarantee that interference will not occur in a particular installation. If this equipment does cause harmful interference to radio or television reception, which can be determined by turning the equipment off and on, the user is encouraged to try to correct the interference by one or more of the following measures:

- Reorient or relocate the receiving antenna.
- Increase the separation between the equipment and receiver.
- Connect the equipment into an outlet on a circuit different from that to which the receiver is connected.
- Consult the dealer or an experienced radio/TV technician for help.

This device complies with part 15 of the FCC Rules. Operation is subject to the following two conditions:

- (1) This device may not cause harmful interference, and
- (2) this device must accept any interference received, including interference that may cause undesired operation.

Changes or modifications not expressly approved by the party responsible for compliance could void the user's authority to operate the equipment.

Hazardous substances and their contents in the item

Part Name	Hazardous Substances									
	Pb	Hg	Cd	Cr(VI)	PBB	PBDE	DIBP	DEHP	DBP	BBP
Main body	X	○	○	○	○	○	○	○	○	○
Battery	○	○	○	○	○	○	○	○	○	○
Ear tips	○	○	○	○	○	○	○	○	○	○
Accessories	○	○	○	○	○	○	○	○	○	○
Charging cable	X	○	○	○	○	○	○	○	○	○

This form is made by SJ/T 11364 regulation.

○: means that hazardous substance content in the homogeneous materials of this part is within the limits of (EU) 2015/863 regulation.

X: means that hazardous substance content in, at least, one certain homogeneous material of this part is beyond the limits of (EU) 2015/863 regulation, but there is no mature alternative in the industry at present, it still conforms to the EU ROHS Directive in the scope of exemption.

Notes: Please arrange using time properly as your hearing may be damaged by using the device for a long time.

Üretici/Manufacturer: Dongguan Hele Electronics Co. Ltd
İthalatç/Importer: Telpa Teknoloji Hizmetleri A.S.
Hamidiye mah. Anadolu Cad.No:14 Kağıthane İSTANBUL/TÜRKİYE



Tips

1. Before using the earbuds, please read the manual carefully and keep it for future references.
2. The earbuds need to be fully charged prior to first-time use.
3. If the earbuds are left unused for over two weeks, please recharge.
4. Please use the chargers made by qualified manufacturer.
5. If the earbuds cannot be found by your phone, please check whether they are in pairing mode; if left unconnected for a long while, the earbuds will exit pairing mode, please re-enter the mode; if a procedure error of your phone occurs, reboot it; if a procedure error of the earbuds occurs, reboot or reset it.

Caveats

1. Never disassemble or modify your earbuds for any reasons to avoid any damages and danger.
2. Do not store the earbuds in extreme temperatures (under 0°C or over 45°C).
3. Avoid using the indicator close to the eyes of children or animals.
4. Do not use the earbuds during a thunderstorm to avoid dysfunction and increasing risk of electric shock.
5. Do not use harsh chemicals or strong detergents to clean the earbuds.

Note: please do not use earbuds for a long time as may damage your hearing.